

AR910

ARRONE® Euro profile mortice sashlock case:

- 60mm or 80mm backset, 72mm centres, case pierced to accept bolt through furniture and escutcheons at horizontal 38mm centres, single square forend or radiused forend
- Single throw, 20mm projection deadbolt
- CE Marked: Certificate: 1121-CPR-AG0067

3	X	8	1*	0	G	4	B	A	3	0
---	---	---	----	---	---	---	---	---	---	---

- CPR Declaration of Performance: HUK0007
- Certifire approved: Certificate CF530
- Meets dimensional recommendations of BS8300 and ADM for locks
- **The AR900 series lock case has been successfully fire tested with the use of an intumescent kit. The supply and fitting of this intumescent kit is essential to the products compliance with the fire test and CE marking evidence it has gained. HOPPE takes no responsibility for any locks purchased and fitted without sufficient intumescent protection.**



square forend



radiused forend

Product ref.	Article description	Finish	Article no.
AR910-S-60-SSS	Mortice sashlock case (60mm backset, square forend)	SSS	87107853
AR910-S-60-PSS	Mortice sashlock case (60mm backset, square forend)	PSS	87107854
AR910-S-60-PB	Mortice sashlock case (60mm backset, square forend)	PB	87107855
AR910-S-80-SSS	Mortice sashlock case (80mm backset, square forend)	SSS	87117085

AR910-R-60-SSS	Mortice sashlock case (60mm backset, radiused forend)	SSS	87107856
AR910-R-60-PSS	Mortice sashlock case (60mm backset, radiused forend)	PSS	87107857
AR910-R-60-PB	Mortice sashlock case (60mm backset, radiused forend)	PB	87107858
AR910-R-80-SSS	Mortice sashlock case (80mm backset, radiused forend)	SSS	87117078

For suitable rebate sets, see page 188

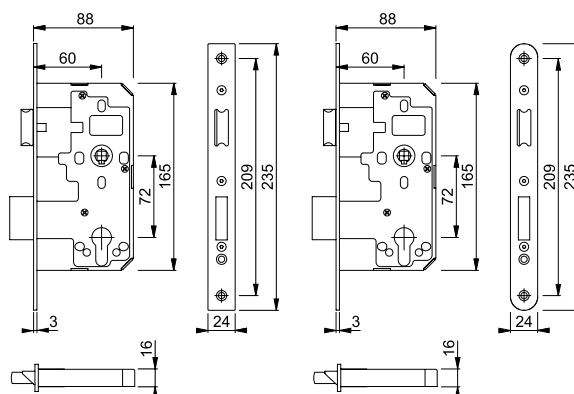

square forend

radiused forend

Included in a successful fire test to BS EN1634 Part-1. Suitable for use on 30, 60, 90 and 120 minute timber and 240 minute steel fire doors

AR911

ARRONE® Euro profile mortice latch case:

- 60mm or 80mm backset, 72mm centres, case pierced to accept bolt through furniture at horizontal 38mm centres, single square forend or radiused forend
- CE Marked: Certificate: 1121-CPR-AG0070

3	X	8	1*	0	G	-	B	0	3	0
---	---	---	----	---	---	---	---	---	---	---

- CPR Declaration of Performance: HUK0009
- Certifire approved: Certificate CF530
- Meets dimensional recommendations of BS8300 and ADM for locks
- **The AR900 series lock case has been successfully fire tested with the use of an intumescent kit. The supply and fitting of this intumescent kit is essential to the products compliance with the fire test and CE marking evidence it has gained. HOPPE takes no responsibility for any locks purchased and fitted without sufficient intumescent protection.**



square forend



radiused forend

Product ref.	Article description	Finish	Article no.
AR911-S-60-SSS	Mortice latch case (60mm backset, square forend)	SSS	87107859
AR911-S-60-PSS	Mortice latch case (60mm backset, square forend)	PSS	87107860
AR911-S-60-PB	Mortice latch case (60mm backset, square forend)	PB	87107861
AR911-S-80-SSS	Mortice latch case (80mm backset, square forend)	SSS	50001772

AR911-R-60-SSS	Mortice latch case (60mm backset, radiused forend)	SSS	87107862
AR911-R-60-PSS	Mortice latch case (60mm backset, radiused forend)	PSS	87107863
AR911-R-60-PB	Mortice latch case (60mm backset, radiused forend)	PB	87107864
AR911-R-80-SSS	Mortice latch case (80mm backset, radiused forend)	SSS	87142637

For suitable rebate sets, see page 188

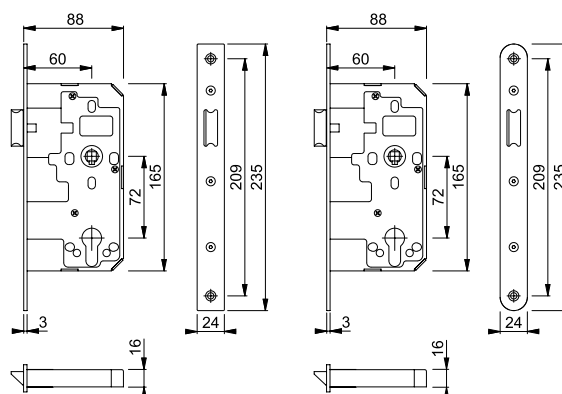

square forend

radiused forend

Included in a successful fire test to BS EN1634 Part-1. Suitable for use on 30, 60, 90 and 120 minute timber and 240 minute steel fire doors

AR912

ARRONE® Euro profile mortice deadlock case:

- 60mm or 80mm backset, case pierced to accept bolt through escutcheons at horizontal 38mm centres, single square forend or radiused forend
- Single throw, 20mm projection deadbolt
- CE Marked: Certificate: 1121-CPR-AG0068
- CPR Declaration of Performance: HUK0008
- Certifire approved: Certificate CF530

3	X	8	1*	0	G	4	B	A	0	0
---	---	---	----	---	---	---	---	---	---	---

- Meets dimensional recommendations of BS8300 and ADM for locks
- **The AR900 series lock case has been successfully fire tested with the use of an intumescent kit. The supply and fitting of this intumescent kit is essential to the products compliance with the fire test and CE marking evidence it has gained. HOPPE takes no responsibility for any locks purchased and fitted without sufficient intumescent protection.**



square forend



radiused forend

Product ref.	Article description	Finish	Article no.
AR912-S-60-SSS	Mortice deadlock case (60mm backset, square forend)	SSS	87107865
AR912-S-60-PSS	Mortice deadlock case (60mm backset, square forend)	PSS	87107866
AR912-S-60-PB	Mortice deadlock case (60mm backset, square forend)	PB	87107867
AR912-S-80-SSS	Mortice deadlock case (80mm backset, square forend)	SSS	50001711
AR912-S-80-PSS	Mortice deadlock case (80mm backset, square forend)	PSS	50001735
AR912-S-80-PB	Mortice deadlock case (80mm backset, square forend)	PB	50001759

AR912-R-60-SSS	Mortice deadlock case (60mm backset, radiused forend)	SSS	87107868
AR912-R-60-PSS	Mortice deadlock case (60mm backset, radiused forend)	PSS	87107869
AR912-R-60-PB	Mortice deadlock case (60mm backset, radiused forend)	PB	87107870
AR912-R-80-SSS	Mortice deadlock case (80mm backset, radiused forend)	SSS	50001723
AR912-R-80-PSS	Mortice deadlock case (80mm backset, radiused forend)	PSS	50001747
AR912-R-80-PB	Mortice deadlock case (80mm backset, radiused forend)	PB	50001760

For suitable rebate sets, see page 188

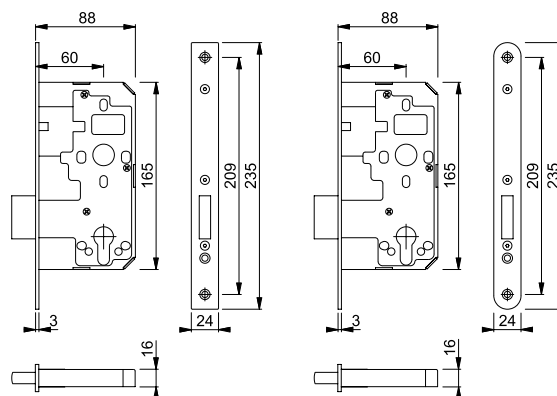

square forend

radiused forend

Included in a successful fire test to BS EN1634 Part-1. Suitable for use on 30, 60, 90 and 120 minute timber and 240 minute steel fire doors

AR913

ARRONE® mortice bathroom lock:

- 60mm or 80mm backset, 78mm centres case pierced to accept bolt through furniture at horizontal 38mm centres, single square forend or radiused forend
- Single throw, 20mm projection deadbolt
- 8mm bathroom follower with 5mm adaptor supplied
- CE Marked: Certificate: 1121-CPR-AG0069

3	X	8	1*	0	G	-	B	0	3	0
---	---	---	----	---	---	---	---	---	---	---

- CPR Declaration of Performance: HUK0010
- Certifire approved: Certificate CF530
- Meets dimensional recommendations of BS8300 and ADM for locks
- **The AR900 series lock case has been successfully fire tested with the use of an intumescent kit. The supply and fitting of this intumescent kit is essential to the products compliance with the fire test and CE marking evidence it has gained. HOPPE takes no responsibility for any locks purchased and fitted without sufficient intumescent protection.**



square forend



radiused forend

For suitable rebate sets, see page 188

Product ref.	Article description	Finish	Article no.
AR913-S-60-SSS	Mortice bathroom lock (60mm backset, square forend)	SSS	87107871
AR913-S-60-PSS	Mortice bathroom lock (60mm backset, square forend)	PSS	87107872
AR913-S-60-PB	Mortice bathroom lock (60mm backset, square forend)	PB	87107873
AR913-S-80-SSS	Mortice bathroom lock (80mm backset, square forend)	SSS	87117099

AR913-R-60-SSS	Mortice bathroom lock (60mm backset, radiused forend)	SSS	87107874
AR913-R-60-PSS	Mortice bathroom lock (60mm backset, radiused forend)	PSS	87107875
AR913-R-60-PB	Mortice bathroom lock (60mm backset, radiused forend)	PB	87107876
AR913-R-80-SSS	Mortice bathroom lock (80mm backset, radiused forend)	SSS	87117092

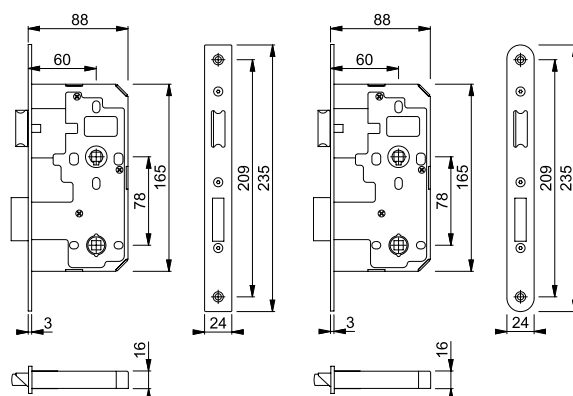

square forend

radiused forend

Included in a successful fire test to BS EN1634 Part-1. Suitable for use on 30, 60, 90 and 120 minute timber and 240 minute steel fire doors

AR914

ARRONE® Euro profile mortice anti thrust nightlatch case:

- 60mm backset, case pierced to accept bolt through furniture at horizontal 38mm centres, single square forend or radiused forend
- Suitable for use with half lever sets, see accessories section for half lever fixing packs
- CE Marked: Certificate: 1121-CPR-AG0071 (BS EN12209), 1121-CPR-ABB010 (BS EN179)

BS EN12209	3	X	8	1*	0	G	-	B	0	3	0
BS EN179	3	7	6	B	1	4	4	1	A	B	
BS EN179	3	7	6	B	1	4	4	1	A	D	

- CPR Declaration of Performance: HUK0011 and HUK0035
- Certifire approved: Certificate CF530
- To comply with BS EN179 certification, only lever handles and associated fixings included in the test evidence must be used.
- Meets dimensional recommendations of BS8300 and ADM for locks
- **The AR900 series lock case has been successfully fire tested with the use of an intumescent kit. The supply and fitting of this intumescent kit is essential to the products compliance with the fire test and CE marking evidence it has gained. HOPPE takes no responsibility for any locks purchased and fitted without sufficient intumescent protection.**
- **PLEASE NOTE: This product is not suitable for use as an actuator when used in conjunction with a reversible panic latch**

Product ref.	Article description	Finish	Article no.
AR914-S-60-SSS	Mortice nightlatch case (60mm backset, square forend)	SSS	87107877
AR914-S-60-PSS	Mortice nightlatch case (60mm backset, square forend)	PSS	87107878
AR914-S-60-PB	Mortice nightlatch case (60mm backset, square forend)	PB	87107879

AR914-R-60-SSS	Mortice nightlatch case (60mm backset, radiused forend)	SSS	87107880
AR914-R-60-PSS	Mortice nightlatch case (60mm backset, radiused forend)	PSS	87107881
AR914-R-60-PB	Mortice nightlatch case (60mm backset, radiused forend)	PB	87107882



square forend



radiused forend

For all spindles and accessories, see page 187

For suitable rebate sets, see page 188

For HOPPE and ARRONE® door furniture certified for use with ARRONE® AR915, AR915-ESC Escape Locks & AR914 Nightlatch, see page 170.

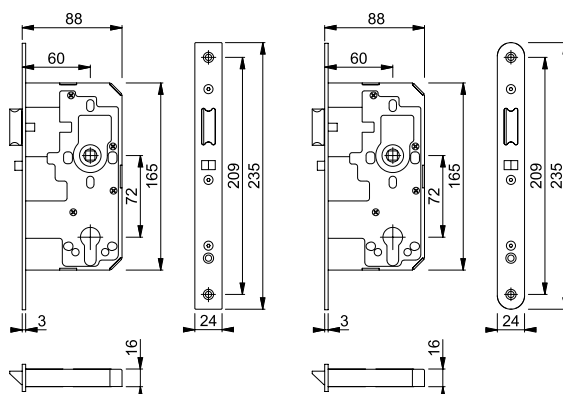

square forend

radiused forend

Included in a successful fire test to BS EN1634 Part-1. Suitable for use on 30, 60, 90 and 120 minute timber and 240 minute steel fire doors

AR915



square forend



radiused forend

For all spindles and accessories, see page 187

For suitable rebate sets, see page 188

For HOPPE and ARNONE® door furniture certified for use with ARNONE® AR915, AR915-ESC Escape Locks & AR914 Nightlatch, see page 170.

ARRONE® Euro profile mortice apartment lock case:

- Single action escape function from inside internal doors
- 60mm backset, 72mm centres, case pierced to accept bolt through furniture and escutcheons at horizontal 38mm centres, single square forend or radiused forend
- Follower: 8mm split follower with self locating plate to allow easy reversibility of the escape function.
- Single throw 20mm projection deadbolt.
- Supplied with AR228A (100mm) and AR228B (120mm) spindles for split follower lock
- CE Marked: Certificate: 1121-CPR-AG0165 (BS EN12209) and 1121-CPR-ABB010 (BS EN179)

BS EN12209	3	X	8	1*	0	G	4	B	A	3	0
BS EN179	3	7	6	B	1	4	4	1	A	B	
BS EN179	3	7	6	B	1	4	4	1	A	D	

- CPR Declaration of Performance: HUK0012 and HUK0035
- Certifire approved: Certificate CF530
- To comply with BS EN179 certification, only lever handles and associated fixings included in the test evidence must be used.
- Meets dimensional recommendations of BS8300 and ADM for locks
- **The AR900 series lock case has been successfully fire tested with the use of an intumescent kit. The supply and fitting of this intumescent kit is essential to the products compliance with the fire test and CE marking evidence it has gained. HOPPE takes no responsibility for any locks purchased and fitted without sufficient intumescent protection.**

- **PLEASE NOTE: This product is not suitable for use as an actuator when used in conjunction with a reversible panic latch**

Product ref.	Article description	Finish	Article no.
AR915-S-60-SSS	Mortice bathroom lock (60mm backset, square forend)	SSS	87107883
AR915-S-60-PSS	Mortice bathroom lock (60mm backset, square forend)	PSS	87107884
AR915-S-60-PB	Mortice bathroom lock (60mm backset, square forend)	PB	87107885

AR915-R-60-SSS	Mortice bathroom lock (60mm backset, radiused forend)	SSS	87107886
AR915-R-60-PSS	Mortice bathroom lock (60mm backset, radiused forend)	PSS	87107887
AR915-R-60-PB	Mortice bathroom lock (60mm backset, radiused forend)	PB	87107888

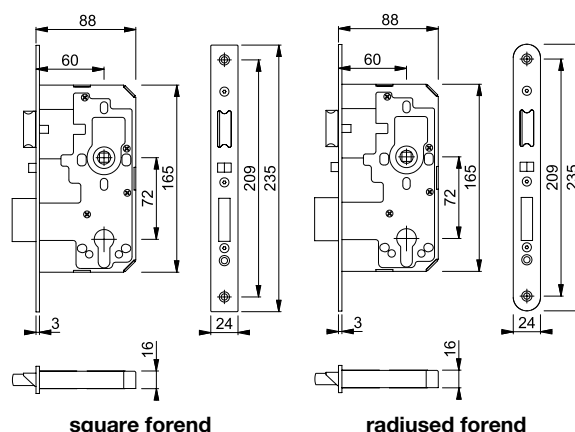

Included in a successful fire test to BS EN1634 Part-1. Suitable for use on 30, 60, 90 and 120 minute timber and 240 minute steel fire doors

AR915-ESC

ARRONE® Euro profile mortice escape lock case:

- Single action escape function internally on external final escape doors
- 60mm backset, 72mm centres, case pierced to accept bolt through furniture and escutcheons at 38mm centres, single square forend or radiused forend
- Non-split follower: 8mm with self locating plate to allow easy reversibility of the escape function.
- Single throw 20mm projection deadbolt.
- AR228F half spindle and AR914/915-HS-Plate available for use with half sets of levers
- CE Marked: Certificate: 1121-CPR-AG0165 (BS EN12209) and 1121-CPR-ABB010 (BS EN179)

BS EN12209	3	X	8	1*	0	G	4	B	A	3	0
BS EN179	3	7	6	B	1	4	4	1	A	B	
BS EN179	3	7	6	B	1	4	4	1	A	D	



square forend



radiused forend

- CPR Declaration of Performance: HUK0012 and HUK0035
- Certifire approved: Certificate CF530
- **To comply with BS EN179 certification, only lever handles and associated fixings included in the test evidence must be used.**
- Meets dimensional recommendations of BS8300 and ADM for locks
- **The AR900 series lock case has been successfully fire tested with the use of an intumescent kit. The supply and fitting of this intumescent kit is essential to the products compliance with the fire test and CE marking evidence it has gained. HOPPE takes no responsibility for any locks purchased and fitted without sufficient intumescent protection.**
- **PLEASE NOTE: This product is not suitable for use as an actuator when used in conjunction with a reversible panic latch**

Product ref.	Article description	Finish	Article no.
AR915-ESC-S-60-SSS	Mortice escape lock case (60mm backset, square forend)	SSS	50001450
AR915-ESC-S-60-PSS	Mortice escape lock case (60mm backset, square forend)	PSS	50001474
AR915-ESC-S-60-PB	Mortice escape lock case (60mm backset, square forend)	PB	50001498

AR915-ESC-R-60-SSS	Mortice escape lock case (60mm backset, radiused forend)	SSS	50001462
AR915-ESC-R-60-PSS	Mortice escape lock case (60mm backset, radiused forend)	PSS	50001486
AR915-ESC-R-60-PB	Mortice escape lock case (60mm backset, radiused forend)	PB	50001504

For all spindles and accessories, see page 187

For suitable rebate sets, see page 188

For HOPPE and ARRONE® door furniture certified for use with ARRONE® AR915, AR915-ESC Escape Locks & AR914 Nightlatch, see page 170.

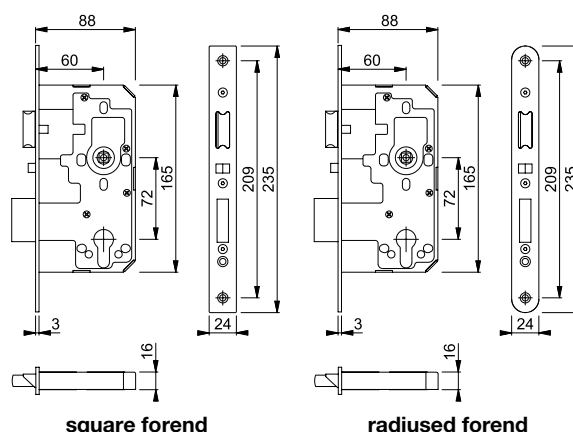

Included in a successful fire test to BS EN1634 Part-1. Suitable for use on 30, 60, 90 and 120 minute timber and 240 minute steel fire doors

AR916

ARRONE® Euro profile mortice rollerbolt lock case:

- Case pierced to accept bolt through escutcheons at horizontal 38mm centres, single square forend or radiused forend
- 60mm or 80mm backset
- Adjustable rollerbolt and single throw deadbolt, 20mm projection
- CE Marked: Certificate: 1121-CPR-AG0247

3	C	8	1*	0	F	2	B	A	0	0
---	---	---	----	---	---	---	---	---	---	---

- CPR Declaration of Performance: HUK0013
- Certifire approved: Certificate CF530
- Meets dimensional recommendations of BS8300 and ADM for locks
- **The AR900 series lock case has been successfully fire tested with the use of an intumescent kit. The supply and fitting of this intumescent kit is essential to the products compliance with the fire test and CE marking evidence it has gained. HOPPE takes no responsibility for any locks purchased and fitted without sufficient intumescent protection.**



square forend



radiused forend

For suitable rebate sets, see page 188

Product ref.	Article description	Finish	Article no.
AR916-S-60-SSS	Mortice Rollerbolt Lock Case (60mm backset, square forend)	SSS	89001310
AR916-S-80-SSS	Mortice Rollerbolt Lock Case (80mm backset, square forend)	SSS	87117071
AR916-R-60-SSS	Mortice Rollerbolt Lock Case (60mm backset, radiused forend)	SSS	89001317
AR916-R-80-PSS	Mortice Rollerbolt Lock Case (80mm backset, radiused forend)	SSS	87117064

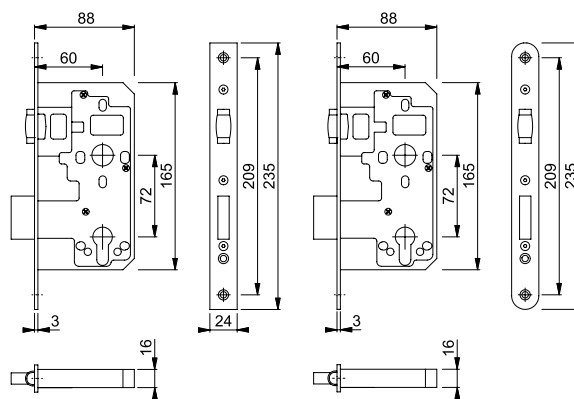

square forend

radiused forend

Included in a successful fire test to BS EN1634 Part-1. Suitable for use on 30, 60, 90 and 120 minute timber and 240 minute steel fire doors

Spindles (Half and Split Follower)

Product ref.	Article description		Article no.
AR228-Pack	Spindle pack to suit AR915, consists of 1 x 100mm, 1 x 120mm spindle and self tapping grub screws		87109443
AR228A-QFP-44	Spindle to suit split follower lock & QFP lever, 8mm x 100mm, hardened steel		50002156
AR228B-QFP-54	Spindle to suit split follower lock & QFP lever, 8mm x 120mm, hardened steel		50002168
AR228C-QFP-64	Spindle to suit split follower lock & QFP lever, 8mm x 140mm		50002175
AR228F-44	Half spindle to suit split follower half set lever furniture, c/w swivel hook, t/s 44mm D.T.		50001644
AR228F-54	Half spindle to suit split follower half set lever furniture, c/w swivel hook, t/s 54mm D.T.		50001656

Half Set Fixing Plates

Product ref.	Article description		Article no.
AR914/915-HS-PLATE	Fixing plate for half levers, to suit AR914 & AR915-ESC locks		87137401

Mortice Tidy

Product ref.	Article description		Article no.
AR81/91-BOX	Black tidy box to suit AR900 and AR8100 series locks		87135861

AR91/81



ARRONE® rebate set:

- 13mm or 25mm rebate sets, suitable for use with all AR900 / AR8100 series locks

Product ref.	Article description	Finish	Article no.
AR91/81-S-13-SSS	13mm rebate set to suit 72mm lockcases	SSS	87107889
AR91/81-S-13-PB	13mm rebate set to suit 72mm lockcases	PB	87108045
AR91/81-S-25-SSS	25mm rebate set to suit 72mm lockcases	SSS	87136610

AR91/81-D-13-SSS	13mm deadlock rebate set to suit 72mm lockcases	SSS	50004153
AR91/81-D-25-SSS	25mm deadlock rebate set to suit 72mm lockcases	SSS	50004165

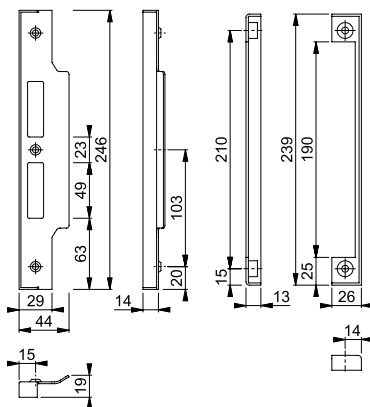

ARRONE® Intumescent Pack AR/INT-DIN-LOCKS

ARRONE® intumescent pack:

- Intumescent pack to suit ARRONE® 72mm centres DIN lockcases
- 1mm thickness
- Consists of:
 - 1 x Lockcase & forend pad
 - 1 x Strikeplate pad

Product ref.	Article description		Article no.
AR/INT-DIN-LOCKS-60	Intumescent pack to suit 72mm locks, 24mm forend, 60mm backset		87134490
AR/INT-DIN-LOCKS-80	Intumescent pack to suit 72mm locks, 24mm forend, 80mm backset		50003410

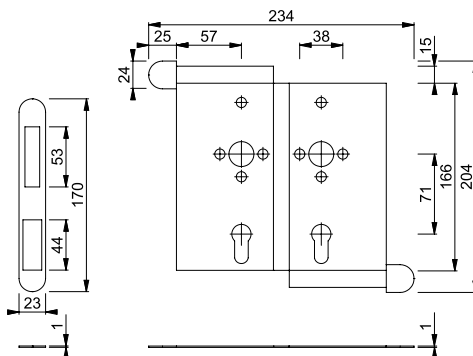

The AR900 and AR8100 series lock cases have been successfully fire tested with the use of this intumescent kit. The supply and fitting of this intumescent kit is essential to the products compliance with the fire test and CE marking evidence it has gained. HOPPE takes no responsibility for any locks purchased and fitted without sufficient intumescent protection.