

4700 Series

Pull handle furniture

A series of pillar fixed round bar pull handles designed to complement the range of lever furniture.

See overleaf for fixing packs and fixing variations.



Certification

- Fire tested to EN 1634 for use on fire doors up to 90 minutes timber / 4hr steel

Features & Functions

- Stainless steel Grade 304
- Pull handles compliant with BS 8300 recommendations
- 32mm diameter
- Each pull handle can be used individually for single sided applications or as a pair mounted back to back
- Standard fixing pack capable of various mounting options (see overleaf)

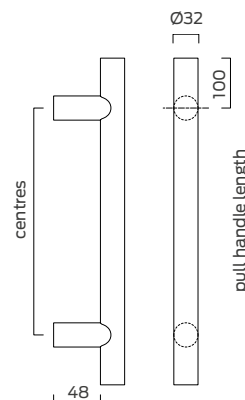

Description:	Pillar pull handle - Round bar section	
Ref:	4724.32.400	4724.32.600
Diameter: mm	32	32
Centres:	200	400

4700 Series

Pull handle furniture

Pull handle fixings

All Briton 4700 Series pull handles can be ordered individually and must be ordered together with a standard fixing pack which contains all the components required to mount the pull handle in any of the 4 applications shown below.

For back to back assembly simply order 2 individual pull handles plus the standard fixing pack.

Ref:	Description
4726	Standard fixing pack for timber, metal or glass doors

Bolt through - single pull handle

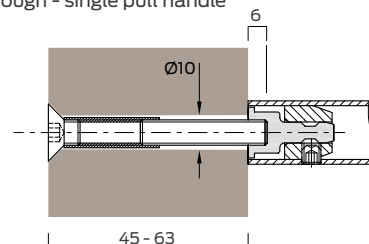

Secret fix - single pull handle

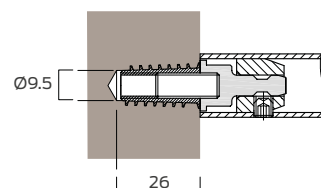

Back to back pair on timber door

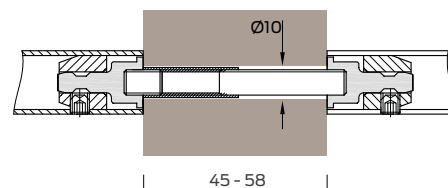

Back to back pair on glass door

