

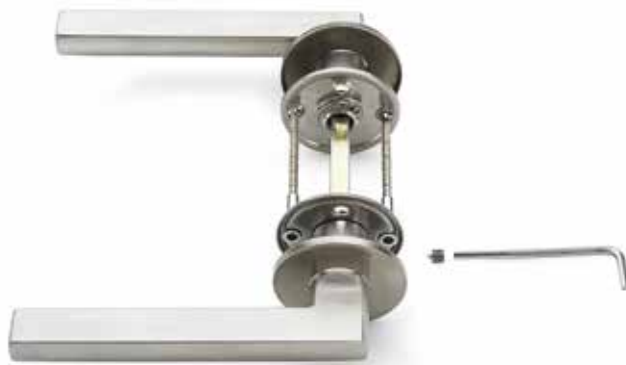

4700 Series

Lever furniture

A range of lever handles in stainless steel Grade 304, suitable for use with all INSPEC euro profile mortice lockcases.



Certification

- EN 1906 - Grade 4
- Fire tested to EN 1634 for use on fire doors up to 90mins timber / 4hr steel
- EN 1670 Grade 3 corrosion resistance

Features & Functions

- Stainless steel Grade 304
- Back to back fixing bolts and threaded bushes on lever furniture provide a strong through fixing.
- Spindle is fixed to the inside and the outside lever handle by "break thru" grub screws providing greater security and durability.
- Grub screw fixings on levers concealed from view on the underside.
- Slimline roses only 4mm thick.
- Precision engineered levers are prefixed to the rose or plate inner by hi-tensile circlip.
- Unique 'ClickFit' system provides a positive snap fit for pressed rose and escutcheon covers.
- Torx head fixings supplied with all leversets and plate mounted levers provide a high quality look and minimise tampering.
- Supplied as a pair with 8mm spindle and bolt through fixings for 44 - 54mm doors

Additional Features

- Specific lever handles are approved for use with Briton 5660 lockcases for emergency escape applications to EN 179 (see table overleaf)
- Fixing packs for thicker doors are available
- Lever handles marked with this icon meet the dimensional recommendations in BS 8300 (see table overleaf)





4700 Series Lever furniture

4701.20.140

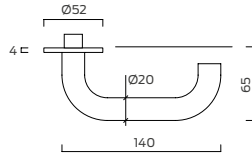

4701.20.175

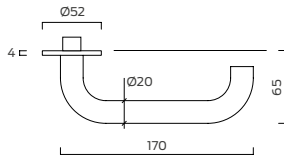

4701.22.140

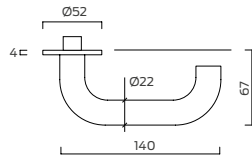

4703.20.140

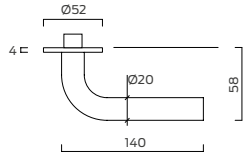

4704

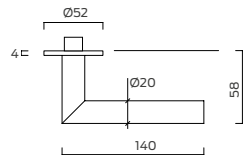

4705.20.140

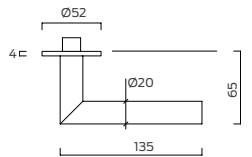

4706

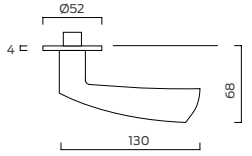

4707

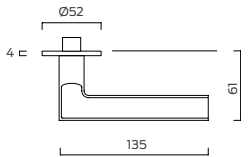

4708

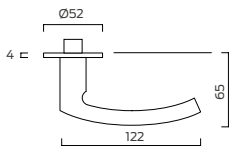

Ref:	EN 1906 Grade 4	EN 179 Approved	BS 8300 Application
4701.20.140	■	■	■
4701.20.175	■	■	■
4701.22.140	■	■	■
4703.20.140	■		
4704	■		
4705.20.140	■		
4706	■		
4707	■		
4708	■		