

Briton

Quality starts with performance and durability

The first point of contact for anyone entering and moving around a building is the door hardware, whether that is a pull handle or a lever handle. In addition to having the right look, the hardware you select must have the right feel and finish and be backed up by a level of performance which will ensure the hardware is suited to the application and the amount of use it will have to endure.

The Briton Specification Series of door hardware is a high quality, high specification range of lever and pull handle door furniture in satin stainless steel. The range encompasses the complete hardware requirement of the large majority of doorsets. Lever furniture features a unique fixing method which provides a firm, positive and highly durable installation. When combined with designs which meet the requirements of BS 8300, successful fire testing to 90 minutes on timber doors and 4 hours on steel doors and our 10 year warranty, Briton Specification Series hardware is ideally suited to new build or refurb installations which require a classical contemporary appeal.



applicable products only

To support the performance characteristics, Briton Specification hardware has the following features:

- Back to back fixing bolts and threaded bushes on lever furniture provide a strong through fixing.
- Spindle is fixed to the inside and the outside lever handle by "break thru" grub screws providing greater security and durability.
- All lever handles achieve EN 1906 Grade 4¹, the highest grade of use within the standard².
- Grub screw fixings on levers concealed from view on the underside.
- Slimline roses only 4mm thick.
- Precision engineered levers are prefixed to the rose or plate inner by hi-tensile circlip.
- Unique 'ClickFit' system provides a positive snap fit for pressed rose and escutcheon covers.
- Torx head fixings supplied with all leversets and plate mounted levers provide a high quality look and minimise tampering.
- Comprehensively tested to EN 1634 for use in timber fire doors up to 90 minutes and steel doors up to 4 hours (see fire test certificate for further details).
- All stainless steel construction Grade 304 with Grade 3 corrosion resistance to EN 1670.

¹ Subject to successful testing commencing January 2015

² Grade 4 category of use is defined as suitable for high frequency use on doors which are subject to frequent violent use, e.g football stadiums, oil rigs, barracks, public toilets.



Ref:	4701.20.140
Type:	Return to door, round bar lever Mounted on 52mm dia. concealed fix roses with bolt through fixings
Dimensions:	Ø20 x 140mm
Certification:	EN 1906 Grade 4 EN 1670 Grade 3 EN 1634 Up to 90 minutes (timber) EN 1634 Up to 4 hour (steel)
Other:	Approved for use with escape locks to EN 179 for emergency exit applications Supplied as a pair with 8mm spindle and bolt through fixings for 44 - 54mm doors*

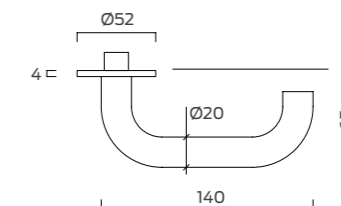

* Alternative fixing pack for 55 - 65mm doors (4701.55-65.FS)

Briton

Classically contemporary style



Ref:	4701.20.175
Type:	Extended return to door, round bar lever Mounted on 52mm dia. concealed fix roses with bolt through fixings
Dimensions:	Ø20 x 175mm
Certification:	EN 1906 Grade 4 EN 1670 Grade 3 EN 1634 Up to 90 minutes (timber) EN 1634 Up to 4 hr (steel)
Other:	Approved for use with escape locks to EN 179 for emergency exit applications Supplied as a pair with 8mm spindle and bolt through fixings for 44 - 54mm doors*

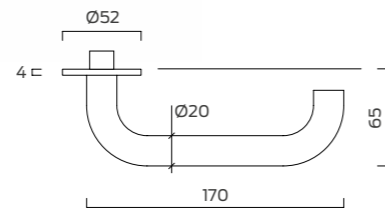

* Alternative fixing pack for 55 - 65mm doors (4701.55-65.FS)



Ref:	4701.22.140
Type:	Return to door, round bar lever Mounted on 52mm dia. concealed fix roses with bolt through fixings
Dimensions:	Ø22 x 140mm
Certification:	EN 1906 Grade 4 EN 1670 Grade 3 EN 1634 Up to 90 minutes (timber) EN 1634 Up to 4 hr (steel)
Other:	Approved for use with escape locks to EN 179 for emergency exit applications Supplied as a pair with 8mm spindle and bolt through fixings for 44 - 54mm doors*

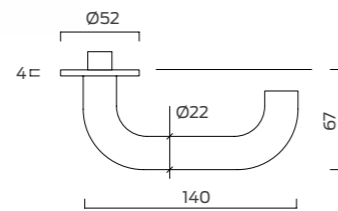

* Alternative fixing pack for 55 - 65mm doors (4701.55-65.FS)



Ref:	4703.20.140
Type:	Straight, round bar lever Mounted on 52mm dia. concealed fix roses with bolt through fixings
Dimensions:	Ø20 x 140mm
Certification:	EN 1906 Grade 4 EN 1670 Grade 3 EN 1634 Up to 90 minutes (timber) EN 1634 Up to 4 hr (steel)
Other:	Supplied as a pair with 8mm spindle and bolt through fixings for 44 - 54mm doors*

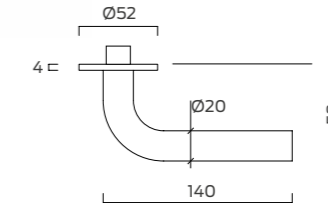

* Alternative fixing pack for 55 - 65mm doors (4701.55-65.FS)



Briton



Ref:	4704
Type:	Straight mitred round bar lever Mounted on 52mm dia. concealed fix roses with bolt through fixings
Dimensions:	Ø20 x 140mm
Certification:	EN 1906 Grade 4 EN 1670 Grade 3 EN 1634 Up to 90 minutes (timber) EN 1634 Up to 4 hr (steel)
Other:	Supplied as a pair with 8mm spindle and bolt through fixings for 44 - 54mm doors*

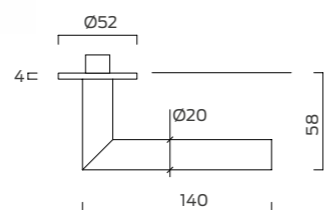

* Alternative fixing pack for 55 - 65mm doors (4701.55-65.FS)



Ref:	4706
Type:	Wing design formed lever Mounted on 52mm dia. concealed fix roses with bolt through fixings
Dimensions:	63 x 130mm
Certification:	EN 1906 Grade 4 EN 1670 Grade 3 EN 1634 Up to 90 minutes (timber) EN 1634 Up to 4 hr (steel)
Other:	Supplied as a pair with 8mm spindle and bolt through fixings for 44 - 54mm doors*

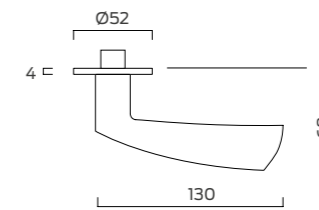

* Alternative fixing pack for 55 - 65mm doors (4701.55-65.FS)



Ref:	4705.20.140
Type:	Curved mitred round bar lever Mounted on 52mm dia. concealed fix roses with bolt through fixings
Dimensions:	Ø20 x 135mm
Certification:	EN 1906 Grade 4 EN 1670 Grade 3 EN 1634 Up to 90 minutes (timber) EN 1634 Up to 4 hr (steel)
Other:	Supplied as a pair with 8mm spindle and bolt through fixings for 44 - 54mm doors*

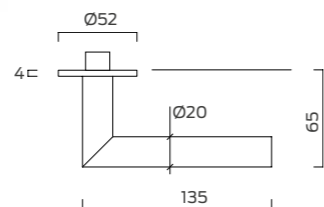

* Alternative fixing pack for 55 - 65mm doors (4701.55-65.FS)



Briton



Ref:	4707
Type:	Hollow cut away flat lever Mounted on 52mm dia. concealed fix roses with bolt through fixings
Dimensions:	56.5 x 135
Certification:	EN 1906 Grade 4 EN 1670 Grade 3 EN 1634 Up to 90 minutes (timber) EN 1634 Up to 4 hr (steel)
Other:	Supplied as a pair with 8mm spindle and bolt through fixings for 44 - 54mm doors*

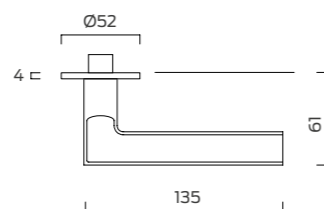

* Alternative fixing pack for 55 - 65mm doors (4701.55-65.FS)



Ref:	4708
Type:	Hollow curve form lever Mounted on 50mm dia. concealed fix roses with bolt through fixings
Dimensions:	60 x 122
Certification:	EN 1906 Grade 4 EN 1670 Grade 3 EN 1634 Up to 90 minutes (timber) EN 1634 Up to 4 hr (steel)
Other:	Supplied as a pair with 8mm spindle and bolt through fixings for 44 - 54mm doors*

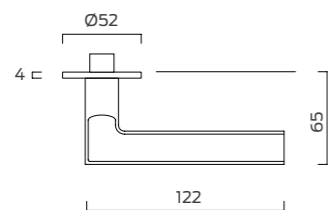

* Alternative fixing pack for 55 - 65mm doors (4701.55-65.FS)



Ref:	4713.4	4714.4	4715.4
Description:	Euro profile cylinder escutcheon	Lever key escutcheon	Blank escutcheon
Dimensions:	Ø52 x 4mm	Ø52 x 4mm	Ø52 x 4mm
Other:	Concealed fixings with snap on cover. Supplied as pairs as standard. Bolt through fixings supplied as standard suitable for doors 44mm-54mm		



Ref:	4710	4711
Description:	Bathroom turn & indicator	Bathroom extended turn & indicator
Dimensions:	Ø52 x 4mm	Ø52 x 4mm
Other:	Supplied with 8mm spindle. Bolt through fixings supplied as standard suitable for doors 44mm-54mm	



Briton



Ref:	4702BP.B.22.140	4702BP.EC.22.140
Description:	Plate mounted lever handle Ø22 Blank plate for use with latches	Plate mounted lever handle Ø22 Backplate with cutout for euro profile cylinders for use with sashlocks
Dimensions:	170 x 170 x 2mm	170 x 170 x 2mm
Certification:	EN 1906 Grade 4 & EN 1670 Grade 3. Included in fire tests to EN 1634 (see fire test reports for further information)	
Other:	Supplied as a pair with bolt through fixings and 8mm spindle suitable for doors 44 - 54mm *	

* Alternative fixing pack for 55 - 65mm doors (4701.55-65.FS)



Ref:	4702BP.WC
Description:	Plate mounted lever handle Ø22 Backplate with bathroom function turn and indicator
Dimensions:	170 x 170 x 2mm
Certification:	EN 1906 Grade 4 & EN 1670 Grade 3. Included in fire tests to EN 1634 (see fire test reports for further information)
Other:	Supplied as a pair with bolt through fixings and 8mm spindle suitable for doors 44 - 54mm* Plate assemblies are handed - see below

* Alternative fixing pack for 55 - 65mm doors (4701.55-65.FS)

Backplate handing



Left hand
4702BP.WC.22.140.SS.L

Right hand
4702BP.WC.22.140.SS.R

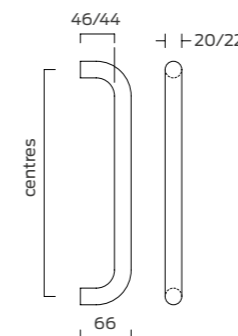
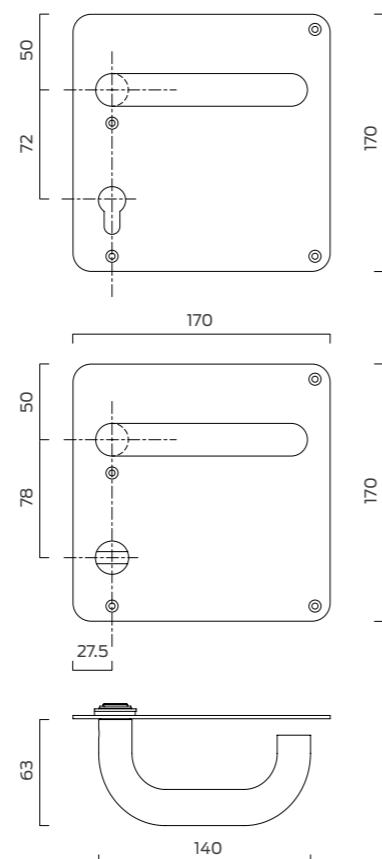

Description:	D pull handle - Round bar section							
Ref:	4721.20.200	4721.22.200	4721.20.300	4721.22.300	4721.20.400	4721.22.400	4721.20.600	4721.22.600
Diameter: mm	20	22	20	22	20	22	20	22
Centres:	200	300	400	600				

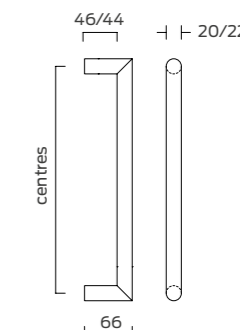

Description:	Mitred handle - Round bar section							
Ref:	4722.20.200	4722.22.200	4722.20.300	4722.22.300	4722.20.400	4722.22.400	4722.20.600	4722.22.600
Diameter: mm	20	22	20	22	20	22	20	22
Centres:	200	300	400	600				

Please note:
Fixing packs for all pull handles must be ordered separately (see page 27)



Briton

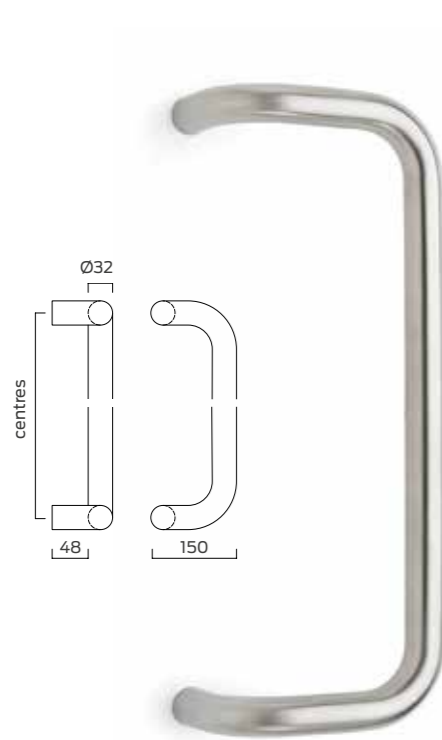

Description:	Cranked pull handle - Round bar section	
Ref:	4723.32.400	4723.32.600
Diameter: mm	32	32
Centres:	400	600



Please note:
Fixing packs for all pull handles must be ordered separately (see page 27)

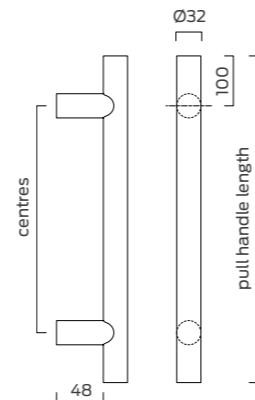

Description:	Pillar pull handle - Round bar section	
Ref:	4724.32.400	4724.32.600
Diameter: mm	32	32
Centres:	200	400



Pull handle fixings

All Briton 4700 Series pull handles can be ordered individually and must be ordered together with a standard fixing pack which contains all the components required to mount the pull handle in any of the 4 applications shown below.

For back to back assembly simply order 2 individual pull handles plus the standard fixing pack.

Bolt through - single pull handle

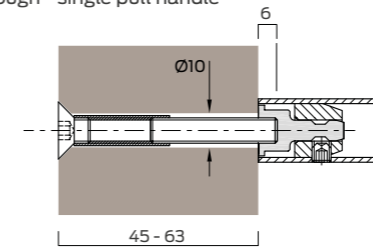

Secret fix - single pull handle

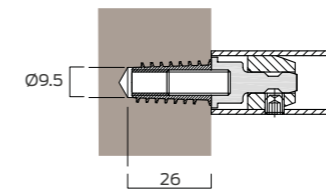

Back to back pair on timber door

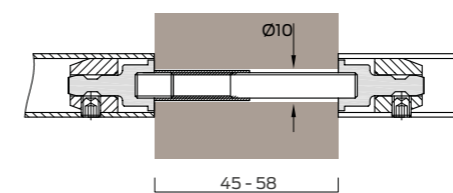

Back to back pair on glass door

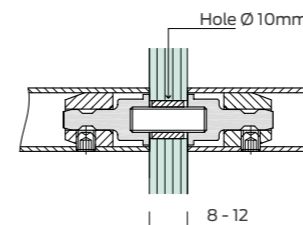

Ref:	Description
4726	Standard fixing pack for timber, metal or glass doors



Rose mount fixings

Briton 4721 and 4722 pull handles can be ordered with an optional face fixed rose. One fixing pack is required for each pull handle and they must be ordered according to the pull handle diameter (20 or 22mm).

Roses are supplied with stainless steel face fixing screws. Snap fit push on covers conceal all fixings.

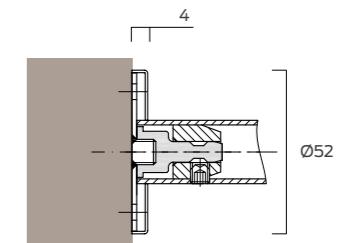

Ref:	Description
4725.20	Face fixed rose mounting kit for 20mm diameter pull handles.
4725.22	Face fixed rose mounting kit for 22mm diameter pull handles.

Briton

A range of accessories completes the integrated door hardware package



Accessories

The Briton Specification Series includes a selection of additional components required to complete a doorset specification. All accessory components are manufactured in satin stainless steel to match the principal items.

For lock cases and cylinders please refer to page 81.

For surface mounted or concealed door controls please refer to page 35.

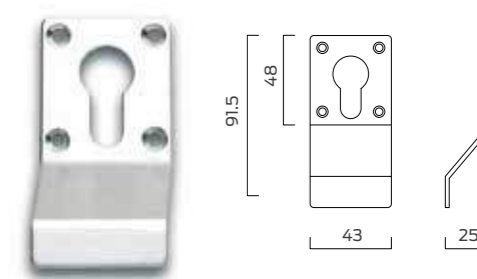

Description:	Push and Pull plates for use with bolt through pull handles	
Options:	Plain or engraved. Radiused corners with face fixing screws. Supplied singly.	
4730.75.375	75mm x 375mm	Plain
4730.75.475	75mm x 475mm	Plain
4730.75.675	75mm x 675mm	Plain
4731.75.375	75mm x 375mm	Engraved 'PUSH'
4731.75.475	75mm x 475mm	Engraved 'PUSH'
4731.75.675	75mm x 675mm	Engraved 'PUSH'
4732.75.375	75mm x 375mm	Engraved 'PULL'
4732.75.475	75mm x 475mm	Engraved 'PULL'
4732.75.675	75mm x 675mm	Engraved 'PULL'

Ref:	Description
4733	Cylinder pull with aperture for euro profile cylinder. Supplied with stainless steel face fixings.

Briton

Symbols & signage

A range of 76mm dia. face fixed stainless steel signs and symbols are available.



Description:	Signs & symbols
Options:	A range of face fixed signs and symbols. All 76mm Ø x 1.5mm stainless steel. Supplied singly complete with wood screw fixings.
Ref:	Description
4750.01	Unisex symbol
4750.02	Male symbol
4750.03	Female symbol
4750.04	Disabled symbol
4750.05	WC sign
4750.06	Shower symbol
4750.07	Baby Change symbol
4750.08	Push
4750.09	Pull
4750.10	Fire door keep shut
4750.11	Fire door keep locked
4750.12	Automatic fire door keep clear



Flush bolts

Used to secure the inactive leaf of an equal or unequal pair of doors. The Briton Specification series includes a range of stainless steel lever action flush bolts. Available square or radius ended and in various lengths to suit door height.

Tested to EN 12051:1999 and Graded 43 - 0131

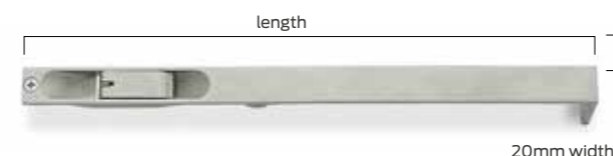

Description:	Flush bolts
Options:	In a range of lengths and with square or radiused ends. Supplied singly with stainless steel fixings.

Ref:	Size	End Type
4735.R.20.202	202mm x 20mm	Radiused
4735.R.20.300	300mm x 20mm	Radiused
4735.R.20.450	450mm x 20mm	Radiused
4735.R.20.600	600mm x 20mm	Radiused
4735.R.20.914	914mm x 20mm	Radiused
4735.S.20.202	202mm x 20mm	Square
4735.S.20.300	300mm x 20mm	Square
4735.S.20.450	450mm x 20mm	Square
4735.S.20.600	600mm x 20mm	Square
4735.S.20.914	914mm x 20mm	Square



Ref:	Description
4736	Plunger type dust excluding floor socket for use with flush bolts - concealed fixing
4737	Easy clean floor socket for use with flush bolts - face fixing.



Description:	Flush bolts - Fully enclosed
Options:	With square or radiused ends. Supplied singly.

Ref:	Size	End Type
4739.R.18.225	225mm x 18mm	Radiused
4739.S.18.225	225mm x 18mm	Square



Ref:	Description
FB41P	Automatic flush bolt - Bolt is actuated by the closing action of the door. Meets ANSI A156.3 Type 25. Supplied as a pair. Fully automatic - inactive door is latched, bolts are extended when active door closes. Bolts retract when active door is opened. Low activation forces - top bolt has no spring tension.

Briton



Ref:	4740	4741	4742	4743
Description:	Domed floor mounted door stop	Floor mounted door stop	Wedge shaped floor mounted door stop	Wall or skirting mounted door stop
Dimensions:	Ø45 x 24mm	Ø40 x 38mm	Ø46 x 26mm	Ø50 x 90mm
Other:	Supplied with stainless steel fixings			

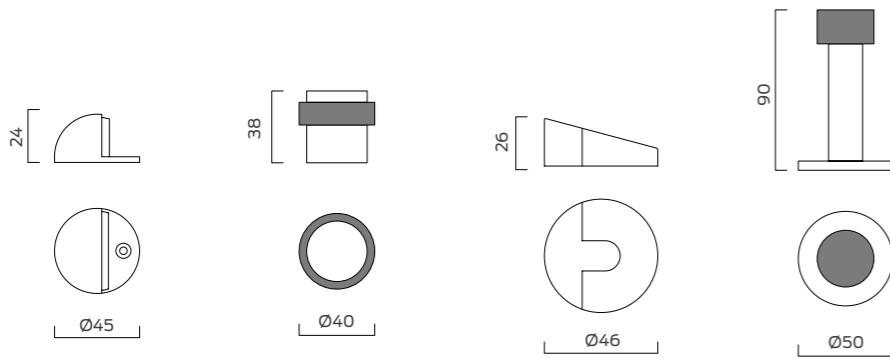

Ref:	Description
482	Security door guard in cast steel



Ref:	Description
U696	Door viewer - small For door thicknesses 35 - 52mm Maximum viewing angle 150°
U698	Door viewer - large For door thicknesses 35 - 54mm Maximum viewing angle 180°

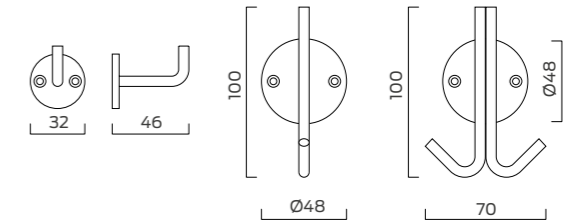

Ref:	Description
4744	Single hook - small, face fixed
4745.1	Single hook - large, face fixed
4745.2	Double hook - large, face fixed
All hooks supplied with stainless steel face fixings	



Briton



Door co-ordinator

The use of a co-ordinator is required for double doors where one leaf must close first, for example rebated double doors fitted with door closing devices. The co-ordinating unit is mounted on the underside of the transom. The trigger arrangement of the co-ordinator ensures the active leaf is held open until the inactive leaf closes and triggers the release of the active leaf.

The Briton door co-ordinator has the following features:

- CE marked and certified to EN 1158
- Aluminium section 41 x 16mm
- Anodised aluminium finish
- Fire tested to EN 1634 for 2 hour rating on timber and mineral composite, 4 hour on steel doors.

Calculating the correct size

The unit is designed to suit equal or unequal pairs according to the minimum door opening widths. The co-ordinator is available in different lengths to suit different door configurations and sizes. The co-ordinator must be at least 150mm longer than the active leaf and less than the overall door opening width measured between frame stops.

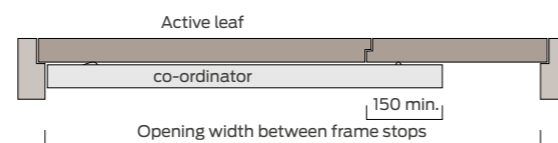

Ref:	Description	For door opening widths
	Door co-ordinator for use with rebated double doors to regulate the closing sequence.	
COR32	Channel length 813mm	864 - 1320mm
COR42	Channel length 1067mm	1320 - 1828mm
COR52	Channel length 1320mm	1575 - 2337mm



Photography by Craig Auckland

The need to satisfy a variety of performance requirements including fire safety, convenience, privacy, disabled access, reliability and the ability to cope with very high traffic requires a robust and comprehensive range of solutions.

The Briton and LCN ranges of door controls are capable of all that and more, whether the application is a busy hospital, school or university or the heavy duty requirements of transport applications.