

SIZE 2-6 ADJUSTABLE BACKCHECK CLOSER SIZE 2-6 ADJUSTABLE BACKCHECK & DELAYED ACTION CLOSER



WARNING
DOOR CLOSER POWER #1 & 2 AND THOSE SUPPLIED WITH MECHANICAL HOLD OPEN DEVICES MUST NOT BE INSTALLED ON FIRE / SMOKE DOORS.

2130/103/00
ISSUE 02

PULL SIDE - REGULAR APPLICATION (FIG. 1)

ANGLE OF OPENING 180° SUBJECT TO HINGE & SURROUNDING STRUCTURE

R.H. DOOR

L.H. DOOR

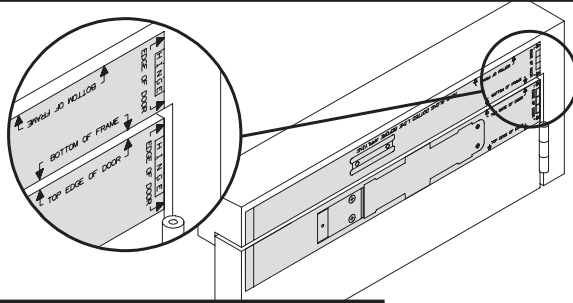
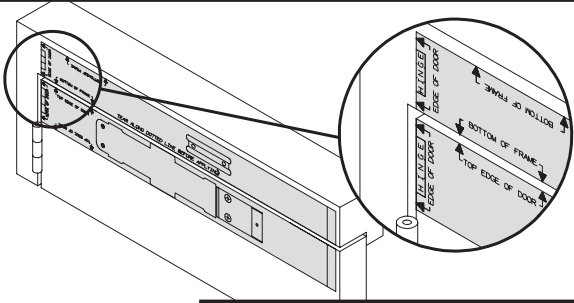

1 PEEL TEMPLATES OFF BACKING PAPER
POSITION ON DOOR/FRAME PILOT DRILL 6 HOLES **1**

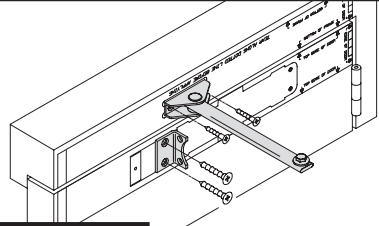
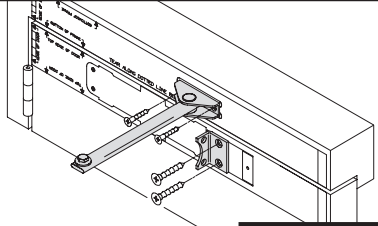

2 FIT MECHANISM BRACKET (2 SCREWS)
FIT ARM BRACKET ASSEMBLY (2 SCREWS) **2**

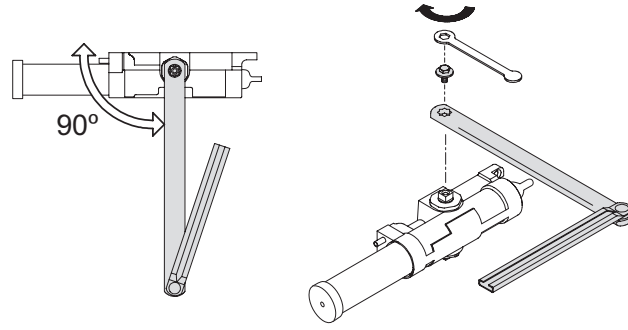
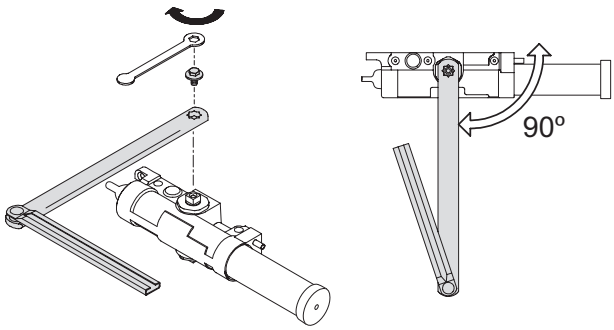

3 FIT MAIN ARM ASSEMBLY TO MECHANISM (90°)
SECURELY TIGHTEN FIXING SCREW WITH SPANNER **3**

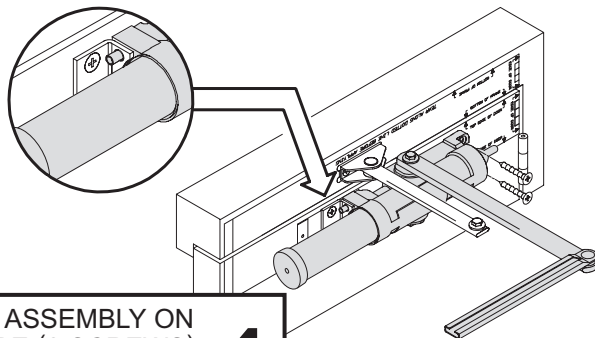
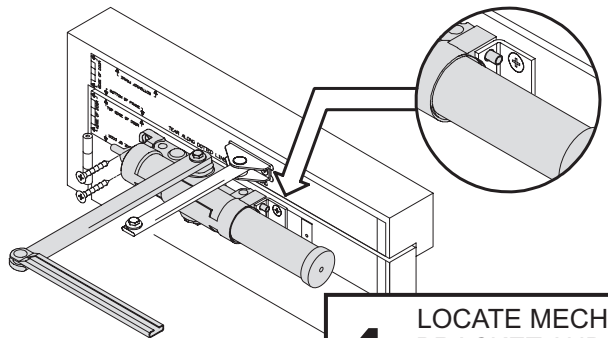

4 LOCATE MECHANISM ASSEMBLY ON
BRACKET AND SECURE (2 SCREWS)
PEEL OFF TEMPLATES **4**

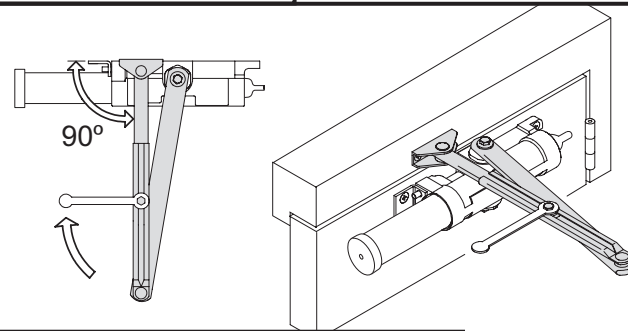
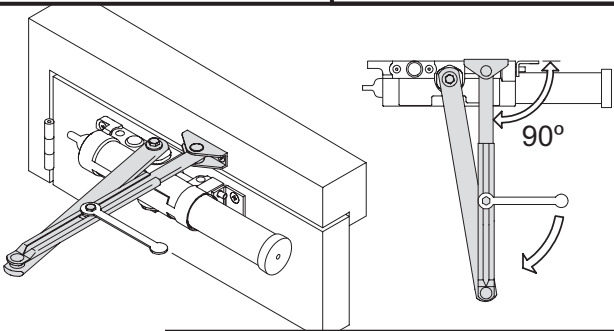

5 OPEN DOOR TO ENGAGE SECONDARY ARM STRIP AND TUBE
CLOSE DOOR AND SET SECONDARY ARM AT 90° TO DOOR FACE
SECURELY TIGHTEN CLAMP BOLT WITH SPANNER **5**

BACKCHECK CLOSER

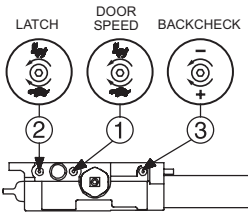

BACKCHECK & DELAYED ACTION CLOSER

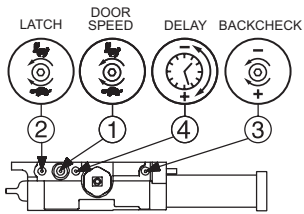

POWER (FIG.1)

FACTORY SET TO SIZE 4	
CLOSER POWER SIZE	NUMBER OF TURNS (APPROX)
2	-6
3	-3
4	0
5	+6
6	+12

6 IF NECESSARY ADJUST POWER AND DOOR SPEEDS **6**

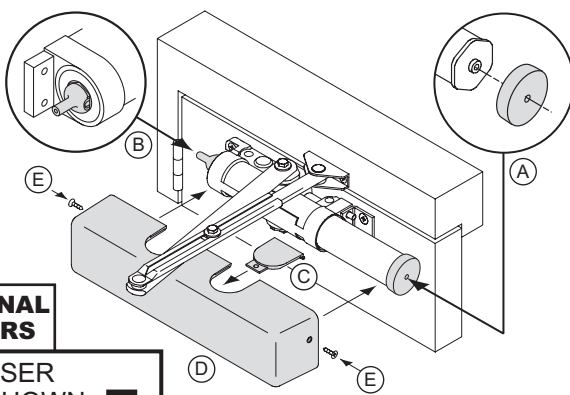
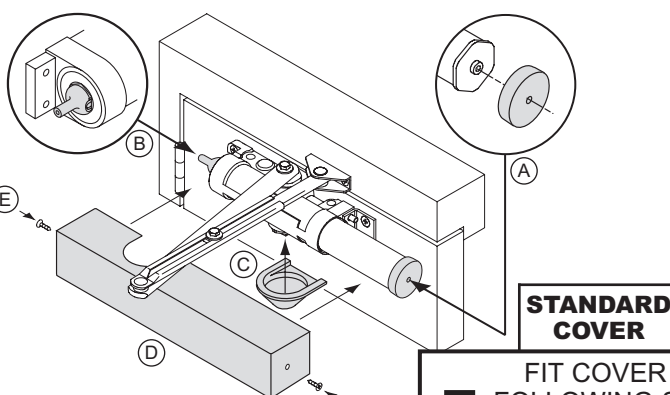

7 FIT COVER TO CLOSER
FOLLOWING STEPS SHOWN
(2 SCREWS) **7**

CLOSER POWER

DOOR SIZE

#1
20kg
750 MAX

#2
40kg
850 MAX

#3
60kg
950 MAX

#4
80kg
1100 MAX

#5
100kg
1250 MAX

#6
120kg
1400 MAX

FOR TRANSON AND PARALLEL ARM INSTALLATION PROCEDURE SEE OVERLEAF

MAINTENANCE (Quarterly)

Check that the door closer closes the door correctly and fixing screws are tight. Periodically apply light oil to arm knuckle joints and door hinges.

NOTE - all dimensions are in millimetres

NOTE - all dimensions are in millimetres

NOTE - all dimensions are in millimetres

NOTE - all dimensions are in millimetres

REGULAR FIXING (FIG.1)

POWER SIZE 2 - 6

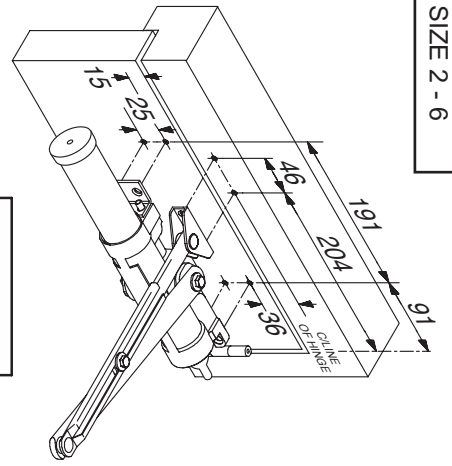
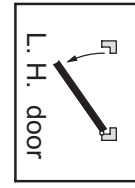
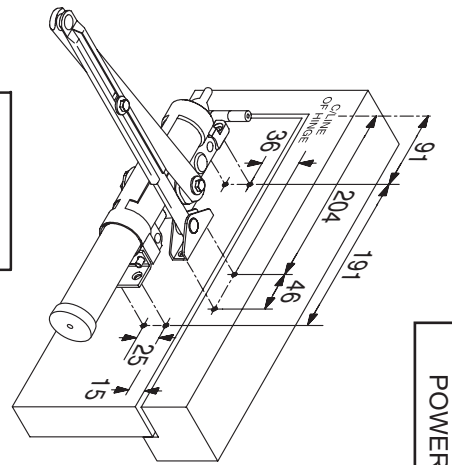
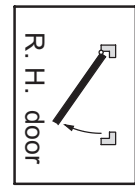

TRANSON FIXING (FIG.61)

POWER SIZE 2 - 6

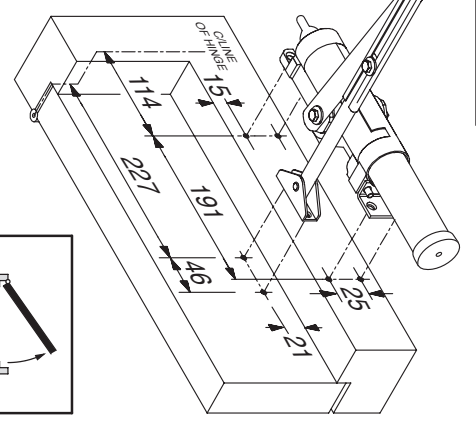
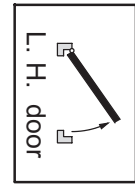
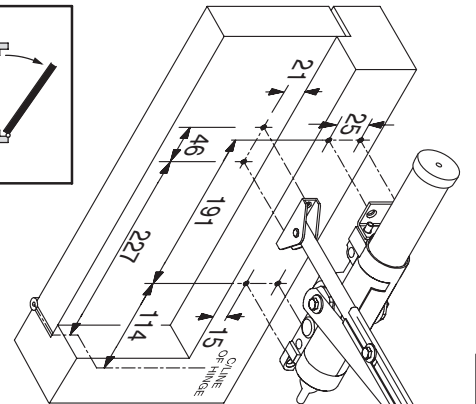
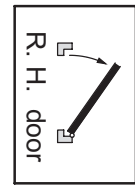

PARALLEL ARM FIXING (FIG.66)

POWER SIZE 1 - 5

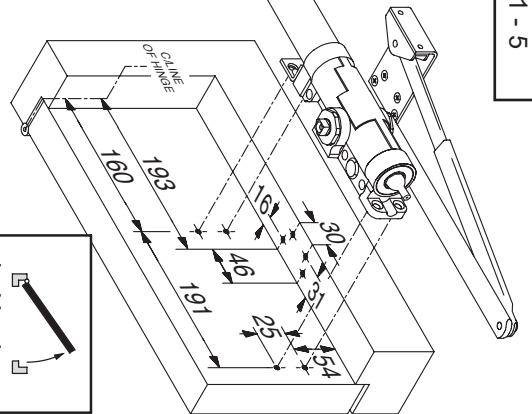
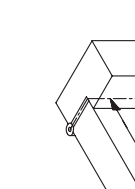
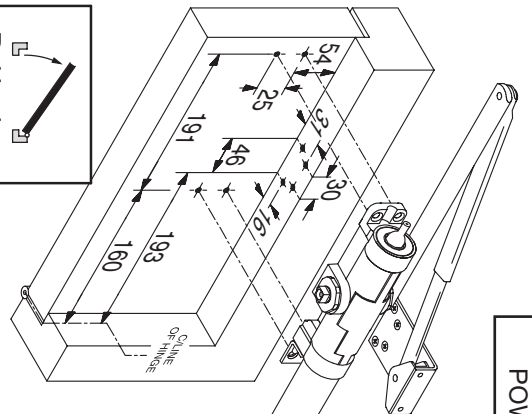
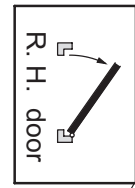

IR
Ingersoll Rand
Security Technologies

PUSH SIDE - PARALLEL ARM APPLICATION (FIG.66)

ANGLE OF OPENING 180° SUBJECT TO HINGE & SURROUNDING STRUCTURE

L.H. DOOR

R.H. DOOR

1 MARK OUT DOOR/FRAME AS DETAILED OVERLEAF PILOT DRILL 8 HOLES

1

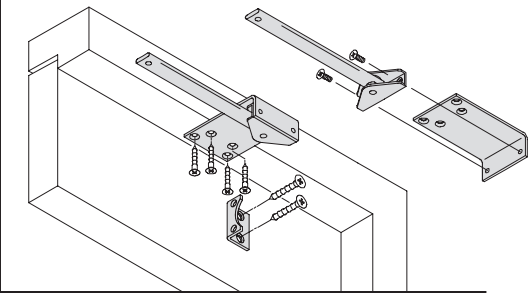
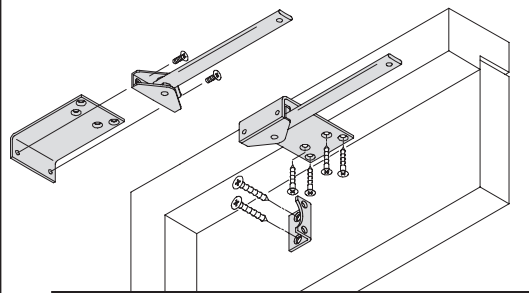
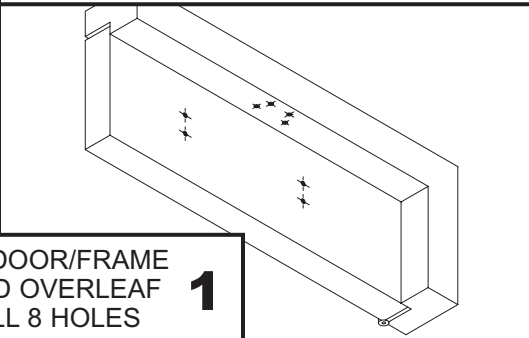
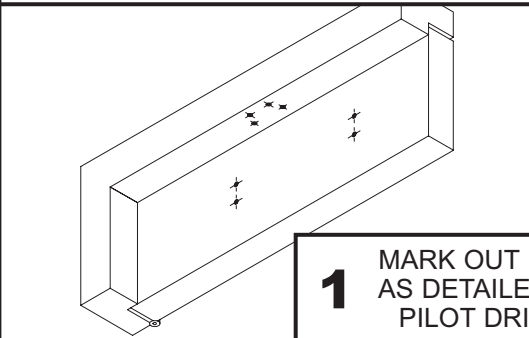

2 FIT MECHANISM BRACKET (2 SCREWS)
FIT ARM BRACKET ASSEMBLY TO FIG.66 BRACKET (2 SCREWS)
FIT BRACKET ASSEMBLY TO FRAME (4 SCREWS)

2

2

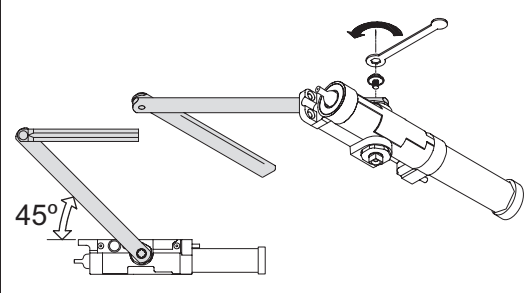
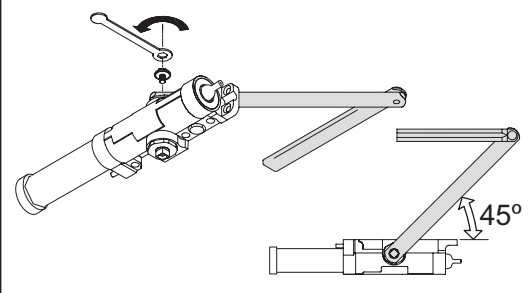

3 FIT MAIN ARM ASSEMBLY TO MECHANISM (45°)
SECURELY TIGHTEN FIXING SCREW WITH SPANNER

3

3

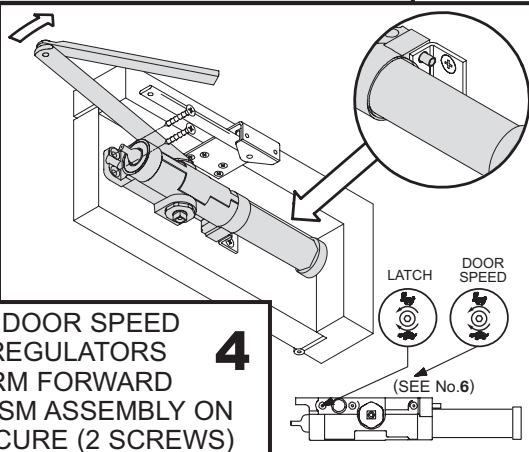
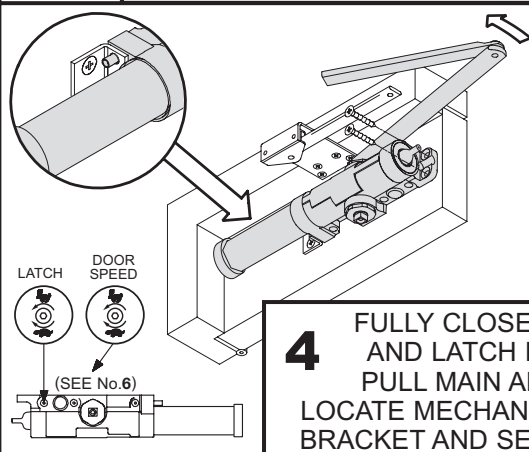

4 FULLY CLOSE DOOR SPEED AND LATCH REGULATORS
PULL MAIN ARM FORWARD
LOCATE MECHANISM ASSEMBLY ON BRACKET AND SECURE (2 SCREWS)

4

4

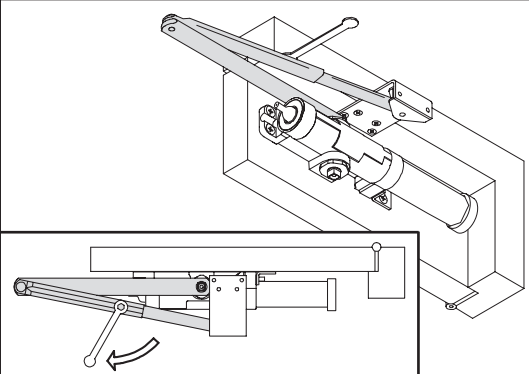
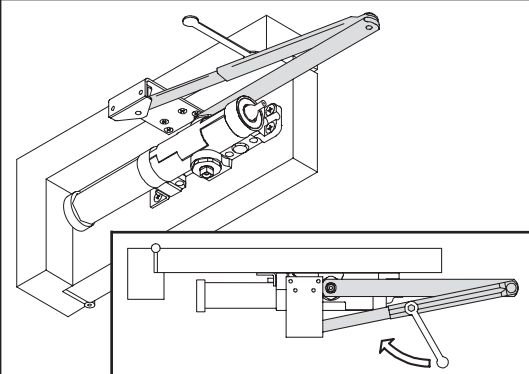

5 OPEN DOOR TO ENGAGE SECONDARY ARM STRIP AND TUBE
CLOSE DOOR AND SET MAIN ARM PARALLEL TO DOOR FACE
SECURELY TIGHTEN CLAMP BOLT WITH SPANNER

5

5

PUSH SIDE TRANSOM APPLICATION (FIG.61)

ANGLE OF OPENING 180° SUBJECT TO HINGE & SURROUNDING STRUCTURE

L.H. DOOR

R.H. DOOR

1 MARK OUT DOOR/FRAME AS DETAILED OVERLEAF PILOT DRILL 6 HOLES

1

1

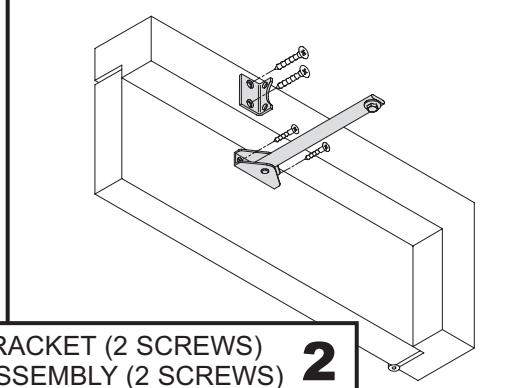
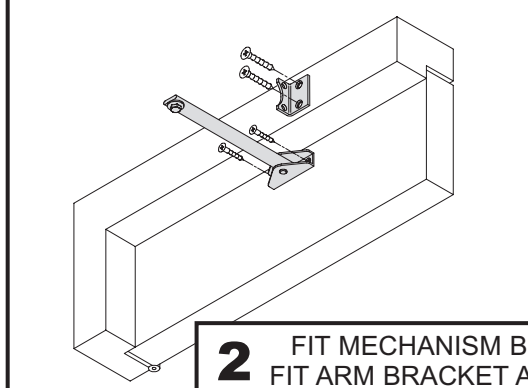
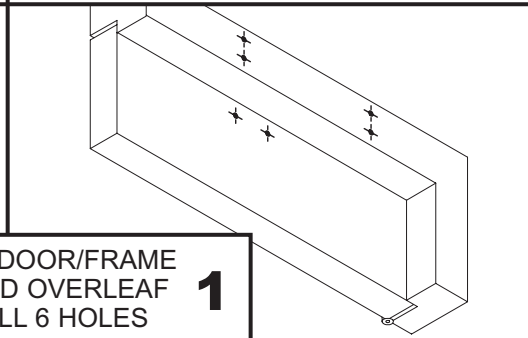
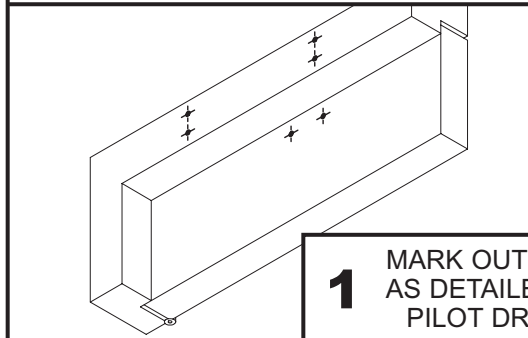

2 FIT MECHANISM BRACKET (2 SCREWS)
FIT ARM BRACKET ASSEMBLY (2 SCREWS)

2

2

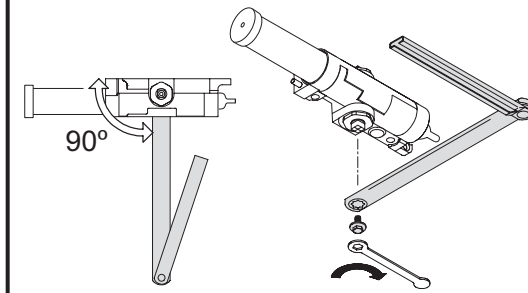
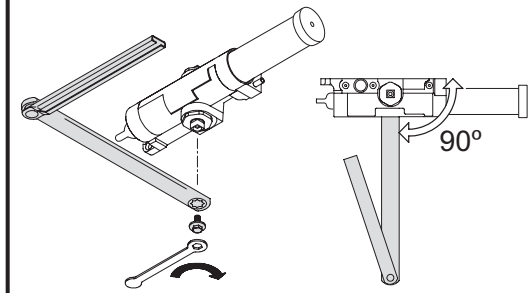

3 FIT MAIN ARM ASSEMBLY TO MECHANISM (90°)
SECURELY TIGHTEN FIXING SCREW WITH SPANNER

3

3

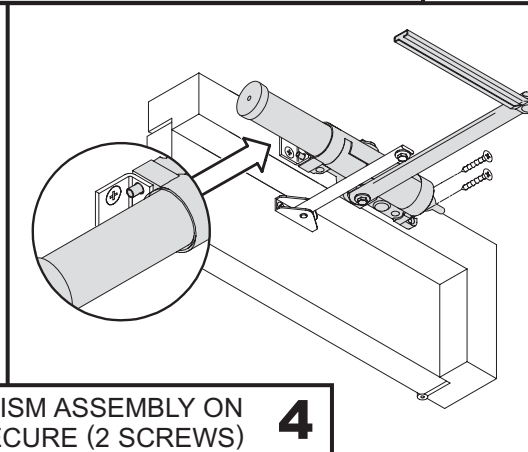
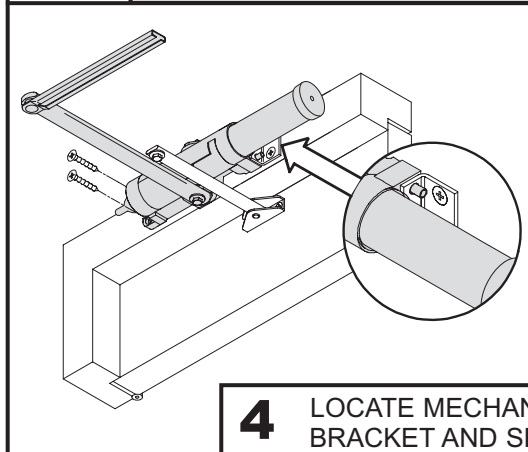

4 LOCATE MECHANISM ASSEMBLY ON BRACKET AND SECURE (2 SCREWS)

4

4

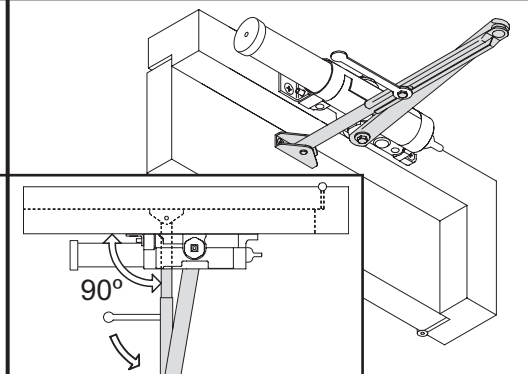
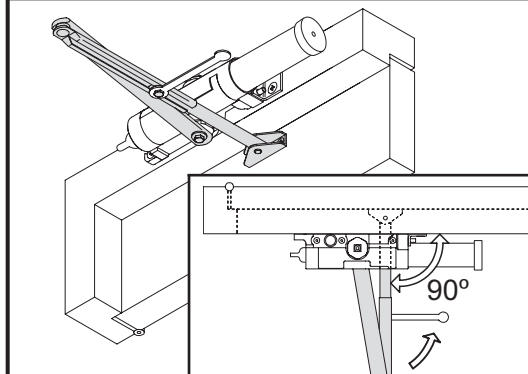

5 OPEN DOOR TO ENGAGE SECONDARY ARM STRIP AND TUBE
CLOSE DOOR AND SET SECONDARY ARM AT 90° TO DOOR FACE
SECURELY TIGHTEN CLAMP BOLT WITH SPANNER

5

5

POWER (FIG.66)

FACTORY SET TO SIZE 3

CLOSER POWER SIZE	NUMBER OF TURNS (APPROX)
1	-6
2	-4
3	0
4	+4
5	+10

BACKCHECK CLOSER

LATCH DOOR SPEED BACKCHECK

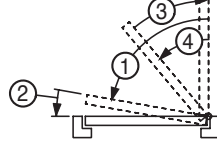
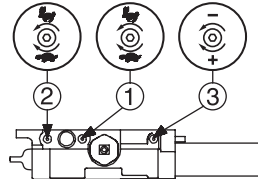

BACKCHECK & DELAYED ACTION CLOSER

LATCH DOOR SPEED DELAY BACKCHECK

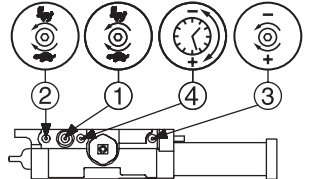

POWER (FIG.61)

FACTORY SET TO SIZE 3

CLOSER POWER SIZE	NUMBER OF TURNS (APPROX)
2	-3
3	0
4	+3
5	+8
6	+12

6 IF NECESSARY ADJUST POWER AND DOOR SPEEDS

6

6

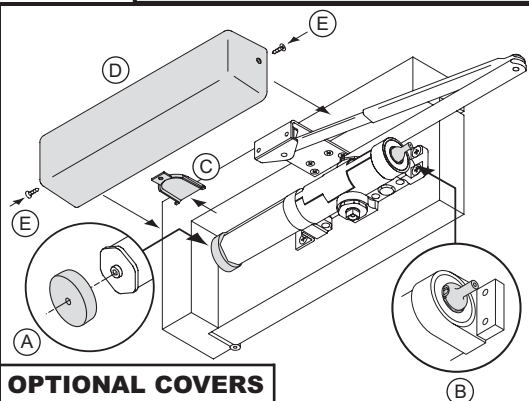
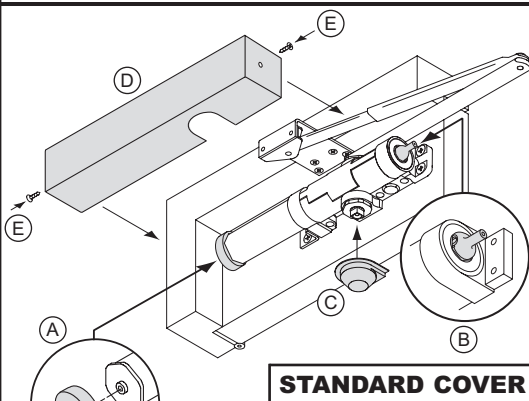

STANDARD COVER OPTIONAL COVERS

7 FIT COVER TO CLOSER FOLLOWING STEPS SHOWN (2 SCREWS)

7

7

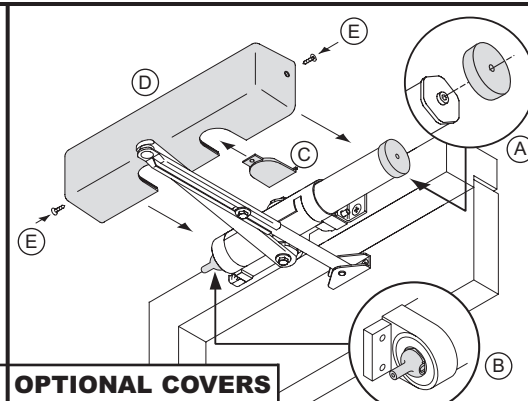
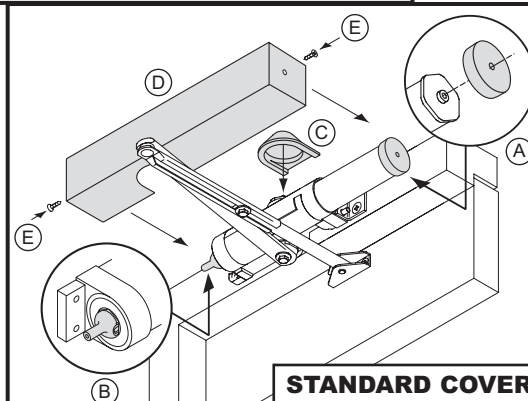

STANDARD COVER OPTIONAL COVERS

7 FIT COVER TO CLOSER FOLLOWING STEPS SHOWN (2 SCREWS)

7

7